



**RUSSELL GAY**  
AND ASSOCIATES

COMMERCIAL REAL ESTATE

**Preston Professional Center**  
3550 NW Cary Parkway  
Cary, NC

### Points of Interest

- 1007 SF available
- Available NOW
- Great location off Cary Parkway
- Custom upfit available
- Private location with wooded views
- \$ 166,000 shell price
- Private wooded view at rear of building with side entry
  
- Other Owners:
  - Dr. Cynthia Gregg,  
Plastic Surgeon
  - Dr. Todd Staker,  
Chiropractor
  - Dr. Paul Kasmer,  
Dentist

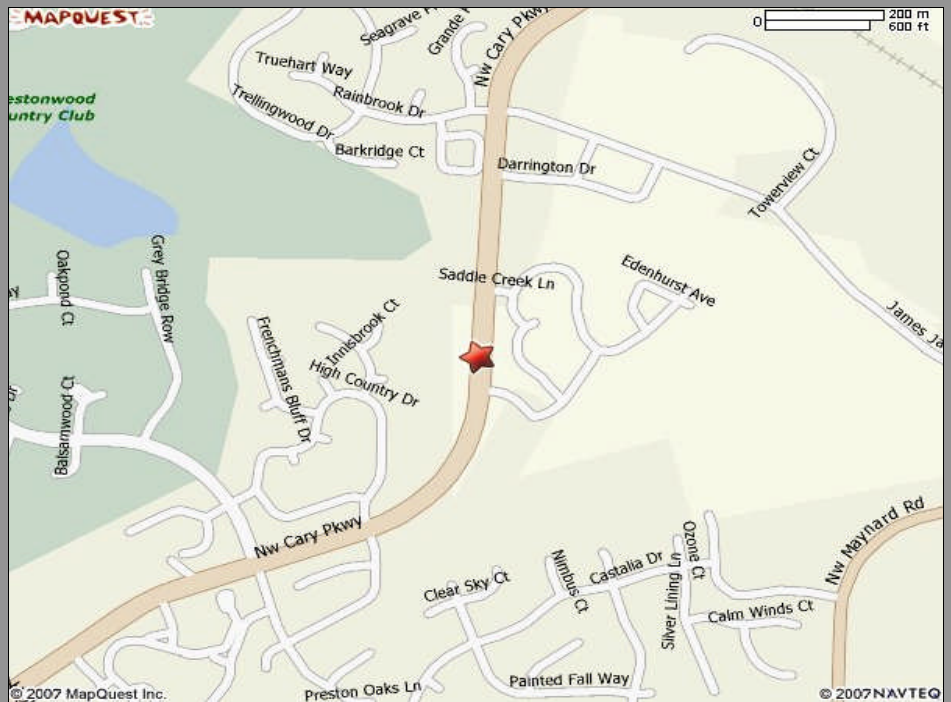

**RUSSELL GAY**

**919-961-8725**

9208 Falls of Neuse Rd, Ste 111  
Raleigh, NC 27615

[www.RUSSELLGAY.COM](http://www.RUSSELLGAY.COM)



**RUSSELL GAY**  
AND ASSOCIATES

COMMERCIAL REAL ESTATE

**Preston Professional Center**

3550 NW Cary Parkway

Cary, NC

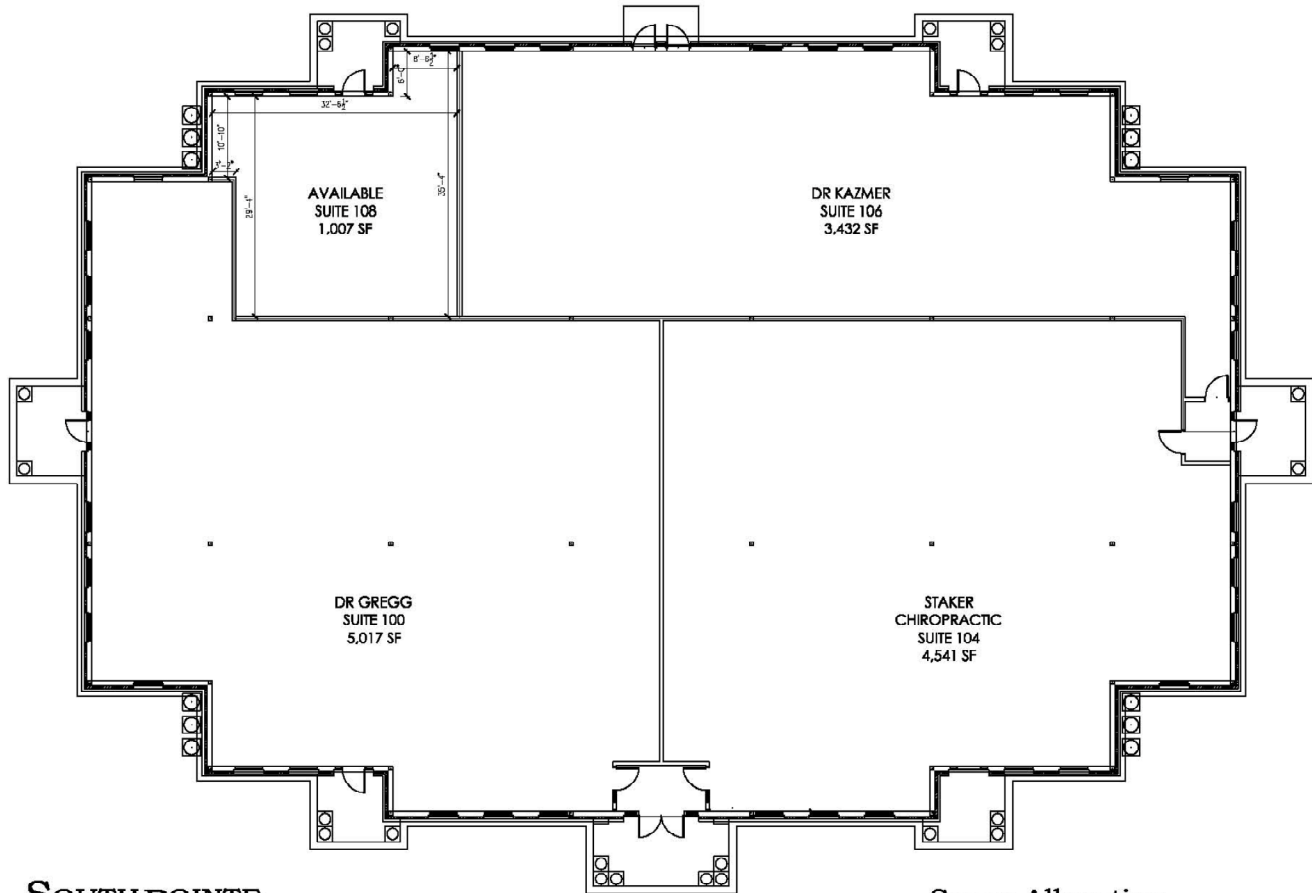

**SOUTH POINTE**  
Builders Developers

9051 Strickland Rd. #121  
Raleigh, NC 27615  
(919) 848-5606 office  
(919) 848-5609 fax

**Space Allocation**  
Suite 108

3550 NW Cary Parkway  
Cary NC

**RUSSELL GAY**

919-961-8725

9208 Falls of Neuse Rd, Ste 111

Raleigh, NC 27615

[www.RUSSELLGAY.COM](http://www.RUSSELLGAY.COM)